

# EVOLVE® Jade 2

EN

V5 - 25/05

## Outdoor antenna for digital and analogue TV signal reception



### Introduction:

It is a new specially designed indoor and outdoor antenna for analogue and terrestrial HDTV broadcasting. It is the best solution. Thanks to the waterproof housing with UV protection, the antenna can be used both indoors and outdoors.

### Technical data:

- Frequency range: 470-694 MHz
- Reception range: UHF
- Antenna gain : max. 48 dBi
- Max. output level : 100 dBuV
- Impedance: 75 Ohm
- Power supply: DC 5V 200 mA
- Noise figure: <4.5 dB
- 5G Filter

### Included in the package:

Check the contents of the package before starting the installation

1. Antenna main unit
2. Power adapter
3. 8 metres + 2 metres of TV coaxial cable including amplifier



### Product features:

- Waterproof cover with UV protection surface.
- Lightweight, compact design and easy installation.
- For receiving analogue and digital TV signals.
- Built-in high gain and low noise
- Powered by DTV set-top box or separate power adapter.
- Special compatibility with HDTVs with a range of digital reception (DVB-T, ISDB-Ti, DTMB, ATSC).

### Antenna installation:

With the supplied accessories, the antenna can be used both indoors and outdoors and can also be mounted on a pole.

**Use the appropriate accessories to mount the antenna on the pole (bracket not included).**

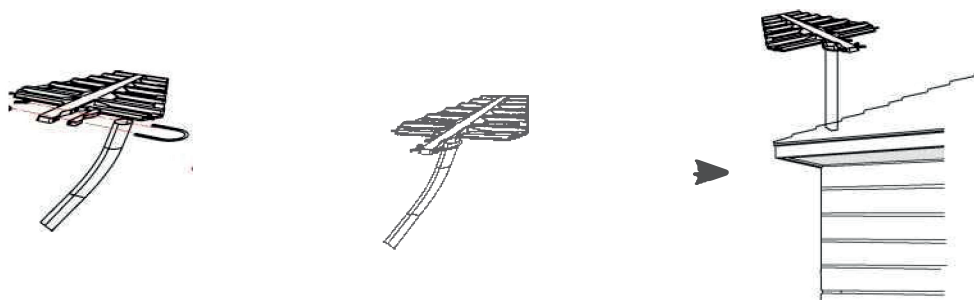

**Installation: Connect the antenna according to the instructions below.**

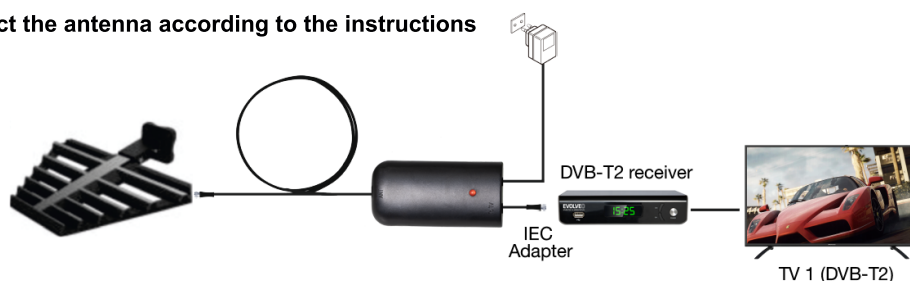

Note: After completing the assembly and installation of the antenna, adjust the antenna to the best position to get a clear TV picture, then secure the antenna and secure the coaxial cable.

### Instruction manual:

Note: For best reception, please check the following conditions

1. Keep the antenna away from sources of interference: keep it away from energy consuming appliances such as air conditioners, elevator, hair dryers and microwave ovens... etc.
2. When used indoors, place the antenna close to windows.
3. Install the antenna as high as possible: when receiving a digital terrestrial signal, obstructions between the antenna and the transmission tower can cause temporary loss of signal. Therefore, if the antenna is installed as high as possible, this loss will be minimized.

Used AC 240V/DC 5V power supply to power the antenna amplifier.

## Power Instruction

### Manufature's name or trade mark, commercial registration number and address

Name:	Guangdong Xinbao Electronic Technology Co., Ltd
Address:	Room 402, Building 1, No.6, Puxin 4th Street, Shipai Town, 523330 Dongguan City, PEOPLE'S REPUBLIC OF CHINA.

### Model identifier

Article:	XBA0500200V1
Description:	Power adapter
Information published	
Input voltage:	AC
Input AC frequency:	50/60
Output voltage	DC
Output current	0.2
Outpput power:	1.0
Average active efficiency:	67.45
Efficiency at low load(10%):	/
No-load power consumption:	0.09



Disposal: The symbol of crossed out container on the product, in the literature or on the wrapping means that in the European Union all the electric and electronic products, batteries and accumulators must be placed into the separate salvage after finishing their lifetime. Do not throw these products into the unsorted municipal waste



### DECLARATION OF CONFORMITY

Hereby, the company Abacus Electric, s.r.o. declares that the EVOLVEO Jade 2 is in compliance with the requirements of the standards and regulations, relevant for the given type of device.

Find the complete text of Declaration of Conformity at <http://ftp.evolveo.com/ce/>

Dovozce / Výrobce - Dovožca / Výrobca  
Importer / Manufacturer - Importőr / Gyártó:  
Abacus Electric, s.r.o.  
Planá 2, 370 01, Česká republika  
Email: [helpdesk@evolveo.com](mailto:helpdesk@evolveo.com)

Made in China

Copyright © Abacus Electric, s.r.o.  
[www.evolveo.com](http://www.evolveo.com)  
[www.facebook.com/EvolveoCZ](https://www.facebook.com/EvolveoCZ)

All rights reserved.  
Design and specification may be changed without prior notice.